

Price Book
Effective January 1, 2008
Prices Subject to Change Without Notice

BELL COMPANY INC.

SIGNAGE SYSTEMS

CAST PLAQUES
CAST LETTERS
CHANNEL LETTERS
CUT LETTERS
STAINLESS STEEL
LETTERS-PLAQUES
ADA SIGNAGE
...and More



Visit us on the web @ BELLCOINC.COM

Plaque Pricing

The plaque at right would be considered a standard plaque and can be priced from the information on this page. Its border, letter style, finish and mounting method are all selected from standard catalog specifications. It has no more than one letter per square inch and does not have any special ornamentation, such as engraving, seals or logos. Plaque layouts with special work must be sent to our estimating department for pricing. If you do not have a layout, you may use this standard pricing but we strongly recommend that you qualify your quotation based on standard plaque requirements as outlined below.



	Bronze	Aluminum
30 Square inches or Less*	\$117.55*	\$85.30*
31 to 50 Square Inches*	\$152.60*	\$117.20*
51 to 99 Square Inches	\$3.55 per square inch	\$2.86 per sq. in.
100 to 160 Square Inches	\$3.34 per square inch	\$2.29 per sq. in.
161 to 1440 Square Inches	\$2.84 per square inch	\$1.79 per sq. in.
1441 to 1728 Square Inches	\$3.03 per square inc	\$1.92 per sq. in.

*Add \$20.00 for approval print if needed. Add 50% to bronze pricing, for cast brass.

NEW Plaques With Uneven Dimensions

Plaque dimensions with fractional sizes will be figured to the next inch. For example: a 12 $\frac{3}{4}$ " x 13" will be figured as a 13" x 13". Contact the factory if you have questions regarding sizes and costs.

Excess Letters

The prices above allows for one letter per square inch. Letters in excess of this allotment will be charged for by the letter at a cost of twenty five (25) cents each.

Ornate Borders

Egg and Dart, Laurel leaf, Ogee, or Lamb's Tongue borders are \$2.00 per linear inch figured on the perimeter measurement of the plaque.

Special Pattern Work

Special letters, engraving, and or, ornamentation such as sculpted figures, seals and ornate borders must be figured at additional cost. See additional pricing on this page or contact the factory with questions.

NEW Approval Prints

Computer generated shop drawings (one set of four copies) are included in the pricing above on plaques over 50 square inches. If returned for resubmittal an additional charge will be applied (\$25.00 minimum).

Full Size Drawings

Full size drawings can be sent in lieu of scaled drawings. The **minimum charge** for this service or for resubmittal in full size is \$55.00. Contact the factory for additional costs.

Flat Relief Etched Portraits and Pictorals

Photo-etched portrait panels can be attached to cast plaques or used separately. Either portraits or artistic renderings can be created using this method. Available in aluminum, brass, bronze or stainless. Pricing is per overall dimensions and thickness...contact factory for further pricing information.

Sculpted (Bas) Relief Portraits and Pictorials

Sculpted relief from your photograph and then cast in bronze, brass or aluminum. Some pricing is given at right. Contact factory for additional information or sizes not listed. Pricing is for single individual photo reproduction. Multiples are available for an additional cost.



Etched Portraits

5" x 7" \$504.00
8" x 10" \$625.00

Bas Relief Portraits

6" - 9" \$1,208.00
10" or 12" \$1,308.00
14" \$1,380.00
16" \$1,428.00
18" \$1,470.00
20" \$1,710.00



Additional Identical Castings

6" - 9" \$310.00
10" - 12" \$375.00
14" \$267.00
16" \$305.00
18" \$342.00
20" \$378.00

Standard Cast Letters

The following prices are for individual letters only and include standard mounting studs. **Templates, adhesive and special hardware are optional and are priced separately on page 15.** Note that lower case letters are sized and priced based on the height of the ascender letters (b, d f, etc.) which are the same height as the capital. Four shop drawing prints can be provided for approval upon request. Contact our sales staff for any pricing not specified herein.

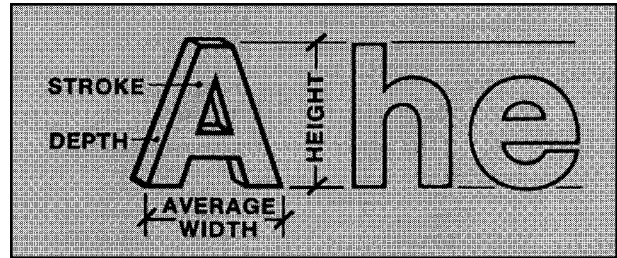

Futura No. 501

A B C D E F G H I J K L M N O P Q R S T U V W X Y Z I 2 3 4 5 6 7 8 9 0 &

DIMENSIONS			
HEIGHT	AVERAGE WIDTH	STROKE	DEPTH
2	1-5/8	5/16	3/8
3	2-7/16	1/2	3/8
4	3-1/4	3/4	3/8
6	5	1-1/4	1
8	6-1/2	1-11/16	1-1/4
10	8-1/4	2	1-1/2
12	9-3/4	2-1/2	2
14	11-1/2	2-1/2	2
16	13	3-3/8	2-1/4
18	14-3/4	3-1/2	2
20	16-1/2	3-1/2	2
22	18-1/2	4	2
24	19-1/2	4	2

ALUMINUM FINISHES				
F-1 Satin Face, Matte Edge, Clear Lacquer	F-1B Buffed Face, Matte Edge, Clear Lacquer	F-4 Satin Face, Matte Edge, Clear Anodized	F-3 Painted Finish F-4A Satin Face, Filed Edge, Clear Anodized	F-6 Bronze or Black Duranodic; Gold Anodized
F-2 Satin Face, Painted Edge	F-2B Buffed Face, Painted Edge			
10.00	22.40	10.50	13.10	17.75
13.00	31.85	13.75	16.95	25.45
16.80	41.60	18.30	22.85	32.10
26.00	63.30	26.65	33.60	47.00
35.05	84.70	36.30	45.35	63.70
45.80	107.90	47.40	59.40	83.45
62.30	136.70	65.90	80.80	112.15
74.00	170.45	76.60	96.10	134.65
97.80	208.15	101.15	127.15	170.20
119.45	272.10	123.30	154.50	207.30
147.00	325.20	151.90	190.50	255.65
174.40	370.10	193.95	209.65	281.05
197.30	410.95	211.40	226.70	308.55

BRONZE FINISHES		
F-7 Satin Face, Oxidized Edge, Clear Lacquer	F-7B Buffed Face, Oxidized Edge, Clear Lacquer	F-10 (US-10B) Antique, Oil Rubbed Satin Face, Matte Edge, Clear Lacquer
F-8 Oxidized Face, & Edge Clear Lacquer		
26.05	38.65	27.40
31.50	50.35	32.95
41.80	66.90	43.75
61.45	99.20	64.00
83.30	133.75	87.05
109.75	172.75	114.75
148.95	224.65	155.90
219.85	308.15	230.90
291.45	392.30	305.95
357.45	467.55	371.50
496.50	568.55	458.20
480.60	625.95	504.70
519.85	678.30	545.60

Add 50% to bronze pricing, for cast brass.

Kabel No. 502

A B C D E F G H I J K L M N O P Q R S T U V W X Y Z I 2 3 4 5 6 7 8 9 0 &

DIMENSIONS			
HEIGHT	AVERAGE WIDTH	STROKE	DEPTH
2	1-3/4	1/4	3/8
3	2	1/2	3/8
4	2-3/4	5/8	3/8
6	4	7/8	1/2
8	5-1/2	1-1/4	5/8
10	7	1-1/2	1
12	8	1-3/4	1
14	9-1/2	2	1
16	10	2-1/8	1
18	12	2-1/4	1

ALUMINUM FINISHES				
F-1 Satin Face, Matte Edge, Clear Lacquer	F-1B Buffed Face, Matte Edge, Clear Lacquer	F-4 Satin Face, Matte Edge, Clear Anodized	F-3 Painted Finish F-4A Satin Face, Filed Edge, Clear Anodized	F-6 Bronze or Black Duranodic; Gold Anodized
F-2 Satin Face, Painted Edge	F-2B Buffed Face, Painted Edge			
10.00	22.40	11.20	13.50	19.10
13.25	31.95	14.55	19.85	25.95
15.35	40.20	16.45	19.95	27.85
21.55	58.80	22.60	28.50	39.55
29.50	79.40	30.70	38.30	53.75
41.25	103.40	42.80	53.85	75.15
49.60	124.30	50.75	61.15	85.75
62.30	156.60	68.85	80.70	112.30
79.90	187.50	90.65	103.80	145.95
91.65	244.60	101.55	120.30	167.85

BRONZE FINISHES		
F-7 Satin Face, Oxidized Edge, Clear Lacquer	F-7B Buffed Face, Oxidized Edge, Clear Lacquer	F-10 (US-10B) Antique, Oil Rubbed Satin Face, Matte Edge, Clear Lacquer
F-8 Oxidized Face, & Edge Clear Lacquer		
32.25	44.95	33.95
33.90	52.75	35.35
36.40	61.60	37.90
51.65	89.60	54.10
70.75	121.30	74.10
98.90	162.15	103.50
142.60	218.50	149.90
184.55	272.85	193.85
237.75	338.40	249.50
276.70	388.70	288.95

Add 50% to bronze pricing, for cast brass.

Gothic No. 503

A B C D E F G H I J K L M N O P Q R S T U V W X Y Z 1 2 3 4 5 6 7 8 9 0 &

DIMENSIONS			
HEIGHT	AVERAGE WIDTH	STROKE	DEPTH
4	3	7/8	3/8
6	4-1/2	1-3/16	1
8	6	1-3/4	3/8
10	7	2	1-1/2
12	8	2-1/4	1-1/8
14	9-1/2	2-3/8	1-1/4
16	11	2-1/2	1-3/8
18	12	3-1/4	1-3/8

ALUMINUM FINISHES				
F-1 Satin Face, Matte Edge, Clear Lacquer	F-1B Buffed Face, Matte Edge, Clear Lacquer	F-4 Satin Face, Matte Edge, Clear Anodized	F-3 Painted Finish F-4A Satin Face, Filed Edge, Clear Anodized	F-6 Bronze or Black Duranodic; Gold Anodized
18.75	43.50	19.45	24.40	32.85
27.60	64.85	28.70	36.00	47.95
27.60	77.10	28.70	36.00	47.95
47.20	109.40	48.90	61.15	82.10
58.95	133.45	61.15	76.65	102.65
69.95	164.30	72.70	90.90	122.00
79.05	187.60	82.95	103.45	139.40
99.65	252.60	103.30	134.35	173.95

BRONZE FINISHES		
F-7 Satin Face, Oxidized Edge, Clear Lacquer	F-7B Buffed Face, Oxidized Edge, Clear Lacquer	F-10 (US-10B) Antique, Oil Rubbed Satin Face, Matte Edge, Clear Lacquer
46.55	71.80	48.85
66.50	104.20	69.40
66.50	116.80	72.90
108.95	176.25	118.40
177.00	252.70	185.80
207.60	296.00	218.00
237.15	337.95	249.00
307.85	421.15	323.05

Add 50% to bronze pricing, for cast brass.

Classic No. 504 (upper & lower case available)

**A B C D E F G H I J K L M N O P Q R S T U V W X Y Z 1 2 3 4 5 6 7 8 9 0 &
a b c d e f g h i j k l m n o p q r s t u v w x y z**

DIMENSIONS			
HEIGHT	AVERAGE WIDTH	STROKE	DEPTH
2	1-3/4	5/16 1/8	3/8
3	2-3/4	1/2 3/16	3/8
4	3-1/2	5/8 1/4	3/8
6	5	1 3/8	1/2
8	7	1-1/4 1/2	3/4
10	8-1/4	1-1/2 1/2	3/4
12	10	1-3/4 5/8	1
14	11	2-1/4 1	1
16	14	2-1/4 1	1
18	15	2-5/8 1-1/4	1-1/2

ALUMINUM FINISHES				
F-1 Satin Face, Matte Edge, Clear Lacquer	F-1B Buffed Face, Matte Edge, Clear Lacquer	F-4 Satin Face, Matte Edge, Clear Anodized	F-3 Painted Finish F-4A Satin Face, Filed Edge, Clear Anodized	F-6 Bronze or Black Duranodic; Gold Anodized
10.85	23.40	11.35	13.50	19.05
16.25	34.80	17.65	19.95	28.05
20.05	44.80	21.85	27.10	34.80
27.15	64.30	28.35	33.75	51.45
36.15	85.75	37.50	44.80	62.60
47.70	109.90	50.50	59.40	83.50
60.30	134.75	64.45	72.10	101.00
69.95	164.35	75.00	81.10	121.50
90.55	198.15	90.55	100.95	141.70
117.95	270.90	121.90	131.20	184.60

BRONZE FINISHES		
F-7 Satin Face, Oxidized Edge, Clear Lacquer	F-7B Buffed Face, Oxidized Edge, Clear Lacquer	F-10 (US-10B) Antique, Oil Rubbed Satin Face, Matte Edge, Clear Lacquer
28.45	41.10	29.75
41.55	60.25	43.35
54.80	80.15	57.25
70.65	108.55	73.90
93.75	144.15	98.10
124.70	187.65	130.10
168.20	244.10	176.35
185.65	273.80	194.80
231.10	331.80	242.70
300.65	413.90	315.55

Add 50% to bronze pricing, for cast brass.

Broadway No. 505

A B C D E F G H I J K L M N O P Q R S T U V W X Y Z 1 2 3 4 5 6 7 8 9 0 &

DIMENSIONS			
HEIGHT	AVERAGE WIDTH	STROKE	DEPTH
2	2	5/8 3/16	3/8
4	3-1/2	1-1/4 3/8	3/8
6	5-1/2	2 1/2	5/8
8	6-1/2	2-1/2 5/8	1
10	8-1/2	3 3/4	1
12	11	4 1	1
14	11-1/2	4-1/4 1-1/8	1
16	15	4-1/4 1-1/2	1
18	16	5 1-1/2	1
20	18	6 2	1-1/2

ALUMINUM FINISHES				
F-1 Satin Face, Matte Edge, Clear Lacquer	F-1B Buffed Face, Matte Edge, Clear Lacquer	F-4 Satin Face, Matte Edge, Clear Anodized	F-3 Painted Finish F-4A Satin Face, Filed Edge, Clear Anodized	F-6 Bronze or Black Duranodic; Gold Anodized
11.80	24.15	13.05	16.10	21.95
16.45	41.30	17.85	21.85	30.30
23.30	60.50	24.40	29.65	42.15
35.30	83.95	36.70	42.30	59.30
45.95	107.95	47.40	59.40	83.50
51.85	126.30	53.40	69.65	97.50
58.80	152.95	60.45	76.05	107.80
81.40	189.15	84.80	106.30	148.55
108.85	261.65	113.05	141.65	198.45
142.55	320.55	147.90	185.55	259.80

BRONZE FINISHES		
F-7 Satin Face, Oxidized Edge, Clear Lacquer	F-7B Buffed Face, Oxidized Edge, Clear Lacquer	F-10 (US-10B) Antique, Oil Rubbed Satin Face, Matte Edge, Clear Lacquer
30.35	43.15	31.90
45.10	70.35	47.20
67.10	105.00	70.35
95.20	145.70	99.70
134.15	197.15	140.20
162.30	237.95	170.35
174.05	262.30	182.60
230.70	331.55	242.40
324.70	439.85	340.95
425.15	412.95	446.50

Add 50% to bronze pricing, for cast brass.

Thin Ribbon No. 506

A B C D E F G H I J K L M N O P Q R S T U V W X Y Z 1 2 3 4 5 6 7 8 9 0 &

DIMENSIONS			
HEIGHT	AVERAGE WIDTH	STROKE	DEPTH
2	1-1/2	1/8	3/4
3	2	3/16	3/4
4	3-1/8	3/16	3/4
6	4-1/2	5/16	1
8	5-1/4	3/8	1
10	7-1/4	1/2	1-1/2
12	8-1/2	5/8	1-1/2
14	10	3/4	2

ALUMINUM FINISHES				
F-1 Satin Face, Matte Edge, Clear Lacquer	F-1B Buffed Face, Matte Edge, Clear Lacquer	F-4 Satin Face, Matte Edge, Clear Anodized	F-3 Painted Finish F-4A Satin Face, Filed Edge, Clear Anodized	F-6 Bronze or Black Duranodic; Gold Anodized
F-2 Satin Face, Painted Edge	F-2B Buffed Face, Painted Edge			
11.90	24.15	12.60	14.85	20.55
16.05	34.55	17.40	19.80	27.85
17.60	42.40	18.85	21.75	30.40
26.45	63.70	28.05	34.40	48.40
35.25	84.85	37.50	45.95	64.35
46.50	108.30	49.00	60.75	85.60
56.70	131.20	59.05	73.80	103.30
75.45	169.65	78.90	98.25	137.85

BRONZE FINISHES		
F-7 Satin Face, Oxidized Edge, Clear Lacquer	F-7B Buffed Face, Oxidized Edge, Clear Lacquer	F-10 (US-10B) Antique, Oil Rubbed Satin Face, Matte Edge, Clear Lacquer
F-8 Oxidized Face, & Edge Clear Lacquer		
27.15	39.75	28.15
34.20	53.10	35.55
41.70	66.85	43.55
63.35	101.20	66.10
84.65	134.95	88.60
112.85	175.85	118.05
172.10	247.75	180.85
224.70	312.90	236.00

Add 50% to bronze pricing, for cast brass.

Heavy Ribbon No. 507

A B C D E F G H I J K L M N O P Q R S T U V W X Y Z 1 2 3 4 5 6 7 8 9 0 &

DIMENSIONS			
HEIGHT	AVERAGE WIDTH	STROKE	DEPTH
2	1-1/2	3/16	3/4
3	2	5/16	3/4
4	3-1/8	1/4	1
6	4-1/2	3/8	1-1/2
8	5-1/4	1/2	1-1/2
10	7-1/4	5/8	2
12	8-1/2	3/4	2
14	10	7/8	2
18	13	7/8	3

ALUMINUM FINISHES				
F-1 Satin Face, Matte Edge, Clear Lacquer	F-1B Buffed Face, Matte Edge, Clear Lacquer	F-4 Satin Face, Matte Edge, Clear Anodized	F-3 Painted Finish F-4A Satin Face, Filed Edge, Clear Anodized	F-6 Bronze or Black Duranodic; Gold Anodized
F-2 Satin Face, Painted Edge	F-2B Buffed Face, Painted Edge			
12.10	24.65	12.95	14.45	19.55
16.40	35.05	16.95	19.30	27.15
23.55	48.30	24.30	27.60	36.95
35.15	72.35	36.25	40.45	56.55
43.50	93.15	45.95	49.75	70.25
56.15	118.00	58.30	64.30	90.05
70.00	144.35	73.25	84.65	104.05
101.55	195.85	105.15	118.65	142.70
152.60	305.55	159.35	176.80	237.40

BRONZE FINISHES		
F-7 Satin Face, Oxidized Edge, Clear Lacquer	F-7B Buffed Face, Oxidized Edge, Clear Lacquer	F-10 (US-10B) Antique, Oil Rubbed Satin Face, Matte Edge, Clear Lacquer
F-8 Oxidized Face, & Edge Clear Lacquer		
25.20	37.90	26.45
33.95	52.80	35.40
48.00	73.30	50.30
74.40	112.15	77.85
101.30	151.70	105.90
131.95	194.80	137.65
197.85	273.45	207.55
272.30	359.80	285.05
405.10	518.50	425.20

Add 50% to bronze pricing, for cast brass.

Olympian No. 508

A B C D E F G H I J K L M N O P Q R S T U V W X Y Z
1 2 3 4 5 6 7 8 9 0 &

DIMENSIONS			
HEIGHT	AVERAGE WIDTH	STROKE	DEPTH
4	6	1/2	1/2
5	7-1/2	5/8	1/2
6	9	3/4	1/2
8	12	1	3/4
10	15	1-1/4	1
12	18	1-1/2	1
14	21	1-3/4	1
16	24	2	1

ALUMINUM FINISHES				
F-1 Satin Face, Matte Edge, Clear Lacquer	F-1B Buffed Face, Matte Edge, Clear Lacquer	F-4 Satin Face, Matte Edge, Clear Anodized	F-3 Painted Finish F-4A Satin Face, Filed Edge, Clear Anodized	F-6 Bronze or Black Duranodic; Gold Anodized
F-2 Satin Face, Painted Edge	F-2B Buffed Face, Painted Edge			
24.05	49.00	24.95	31.05	43.35
29.40	60.50	30.40	38.10	50.80
34.85	72.25	36.20	43.20	63.65
60.05	109.65	62.55	69.95	93.15
81.70	143.75	84.85	89.85	128.60
91.70	166.10	94.80	122.75	159.80
114.45	208.60	126.70	151.05	199.90
132.55	240.10	147.00	167.10	224.30

BRONZE FINISHES		
F-7 Satin Face, Oxidized Edge, Clear Lacquer	F-7B Buffed Face, Oxidized Edge, Clear Lacquer	F-10 (US-10B) Antique, Oil Rubbed Satin Face, Matte Edge, Clear Lacquer
F-8 Oxidized Face, & Edge Clear Lacquer		
74.40	99.65	77.85
91.45	122.80	95.40
108.75	146.55	113.60
149.25	199.75	158.00
197.15	260.35	206.15
286.55	362.25	300.95
346.00	434.10	364.85
382.90	483.75	402.00

Add 50% to bronze pricing, for cast brass.

Marshall No. 510

A B C D E F G H I J K L M N O P Q R S T U V W X Y Z 1 2 3 4 5 6 7 8 9 0 &

DIMENSIONS			
HEIGHT	AVERAGE WIDTH	STROKE	DEPTH
3	2-1/2	3/8	3/8
4	2-3/4	7/16	3/8
6	4	11/16	5/8
8	5-1/2	7/8	3/4
9	6	1	1
10	7	1-1/4	1
12	9	1-3/8	1-1/8
15	10	1-3/4	1-3/8
18	12	2	1-1/2
20	14	2-1/2	1-5/8

ALUMINUM FINISHES				
F-1 Satin Face, Matte Edge, Clear Lacquer	F-1B Buffed Face, Matte Edge, Clear Lacquer	F-4 Satin Face, Matte Edge, Clear Anodized	F-3 Painted Finish F-4A Satin Face, Filed Edge, Clear Anodized	F-6 Bronze or Black Duranodic; Gold Anodized
16.70	35.40	17.80	19.35	26.60
17.35	42.20	18.50	20.10	27.60
24.95	62.25	26.20	28.45	41.15
30.55	80.25	34.05	39.65	53.25
34.05	89.85	37.50	42.30	56.60
40.60	102.75	44.65	49.60	70.25
50.25	124.60	54.95	64.25	89.85
71.60	172.60	76.25	89.55	125.85
92.85	245.85	103.10	120.90	169.55
122.20	299.45	131.15	163.10	228.55

BRONZE FINISHES		
F-7 Satin Face, Oxidized Edge, Clear Lacquer	F-7B Buffed Face, Oxidized Edge, Clear Lacquer	F-10 (US-10B) Antique, Oil Rubbed Satin Face, Matte Edge, Clear Lacquer
38.20	57.00	39.90
49.00	74.10	50.95
68.70	106.70	71.90
93.90	144.35	98.20
101.50	158.30	106.15
112.00	175.20	117.15
150.10	225.55	157.50
201.55	299.60	215.40
274.80	388.35	288.55
374.75	495.40	393.45

Add 50% to bronze pricing, for cast brass.

Huxley Modern No. 511

A B C D E F G H I J K L M N O P Q R S T U V W X Y Z 1 2 3 4 5 6 7 8 9 0 &

DIMENSIONS			
HEIGHT	AVERAGE WIDTH	STROKE	DEPTH
3	1-1/4	1/4	3/4
4	1-3/8	1/4	3/4
6	2	3/8	1-1/8
8	2-5/8	1/2	1-1/2
10	3-3/8	5/8	2
12	4	3/4	2-1/4
14	4-5/8	7/8	2-5/8
16	5-3/8	1	3

ALUMINUM FINISHES				
F-1 Satin Face, Matte Edge, Clear Lacquer	F-1B Buffed Face, Matte Edge, Clear Lacquer	F-4 Satin Face, Matte Edge, Clear Anodized	F-3 Painted Finish F-4A Satin Face, Filed Edge, Clear Anodized	F-6 Bronze or Black Duranodic; Gold Anodized
15.65	34.25	17.35	20.15	28.20
20.05	44.80	22.20	27.10	37.65
30.15	67.60	31.10	39.20	54.60
40.35	89.85	41.40	51.75	72.55
51.75	113.85	55.00	67.55	94.10
67.75	142.20	70.20	87.80	123.50
89.80	184.10	97.00	121.15	170.05
115.50	223.20	126.30	150.40	210.75

BRONZE FINISHES		
F-7 Satin Face, Oxidized Edge, Clear Lacquer	F-7B Buffed Face, Oxidized Edge, Clear Lacquer	F-10 (US-10B) Antique, Oil Rubbed Satin Face, Matte Edge, Clear Lacquer
34.00	52.90	35.55
50.30	75.50	52.60
77.65	115.75	81.35
112.00	162.50	117.15
150.85	214.00	157.65
205.25	280.80	215.40
277.50	365.90	291.40
344.35	445.10	361.50

Add 50% to bronze pricing, for cast brass.

Condensed Ribbon No. 512

A B C D E F G H I J K L M N O P Q R S T U V W X Y Z 1 2 3 4 5 6 7 8 9 0 &

DIMENSIONS			
HEIGHT	AVERAGE WIDTH	STROKE	DEPTH
3	1-3/8	1/4	3/4
4	1-5/8	5/16	1
6	2-1/2	3/8	1-1/8
8	3-1/2	1/2	1-1/2
9	3-3/4	7/16	1-1/2
10	4-1/4	1/2	1-1/2
12	5	1/2	1-7/8
15	6-1/4	5/8	2-1/8

ALUMINUM FINISHES				
F-1 Satin Face, Matte Edge, Clear Lacquer	F-1B Buffed Face, Matte Edge, Clear Lacquer	F-4 Satin Face, Matte Edge, Clear Anodized	F-3 Painted Finish F-4A Satin Face, Filed Edge, Clear Anodized	F-6 Bronze or Black Duranodic; Gold Anodized
15.65	34.30	16.45	18.50	28.05
20.75	45.65	22.30	23.70	36.20
30.00	67.50	32.25	34.55	50.35
37.50	87.25	39.70	42.40	59.55
43.60	99.50	45.65	52.40	70.05
51.75	113.85	54.35	61.75	78.70
67.95	142.60	71.80	78.45	107.30
96.35	197.20	101.45	111.40	139.90

BRONZE FINISHES		
F-7 Satin Face, Oxidized Edge, Clear Lacquer	F-7B Buffed Face, Oxidized Edge, Clear Lacquer	F-10 (US-10B) Antique, Oil Rubbed Satin Face, Matte Edge, Clear Lacquer
38.30	57.05	40.05
49.95	75.20	52.20
74.45	112.15	77.95
94.90	145.55	99.00
117.50	174.30	122.80
139.55	201.70	144.90
183.00	258.75	191.80
254.90	349.55	267.70

Add 50% to bronze pricing, for cast brass.

Architectural Prismatic No. 514

ABCDEFGHIJKLMNOPQRSTUVWXYZ 1 2 3 4 5 6 7 8 9 0 &

DIMENSIONS				
HEIGHT	AVERAGE WIDTH	STROKE		DEPTH
3	3	1/2	1/4	3/8
4	4	5/8	3/8	5/8
6	5-1/2	7/8	1/2	5/8
8	7-1/2	1-1/8	5/8	3/4
10	9-1/2	1-3/8	11/16	3/4
12	11-1/2	1-1/2	3/4	7/8
14	13	2	7/8	7/8
16	15	2-1/4	1	1
18	17-1/8	2-5/8	1-1/4	1
20	18	2-7/8	1-1/2	1

ALUMINUM FINISHES				
F-1 Satin Face, Matte Edge, Clear Lacquer	F-1B Buffed Face, Matte Edge, Clear Lacquer	F-4 Satin Face, Matte Edge, Clear Anodized	F-3 Painted Finish F-4A Satin Face, Filed Edge, Clear Anodized	F-6 Bronze or Black Duranodic; Gold Anodized
F-2 Satin Face, Painted Edge	F-2B Buffed Face, Painted Edge			
25.85	44.75		29.00	50.65
31.60	56.55		35.10	56.60
39.65	76.90		43.95	76.20
49.75	99.45		55.45	96.30
65.60	127.70		72.95	108.70
78.40	152.75		91.35	132.65
105.80	200.00		117.45	140.55
139.15	246.90		159.00	184.75
166.65	319.75		185.25	221.75
209.25	387.25		232.70	278.70

BRONZE FINISHES		
F-7 Satin Face, Oxidized Edge, Clear Lacquer	F-7B Buffed Face, Oxidized Edge, Clear Lacquer	F-10 (US-10B) Antique, Oil Rubbed Satin Face, Matte Edge, Clear Lacquer
F-8 Oxidized Face, & Edge Clear Lacquer		
54.80	74.50	63.00
64.60	86.80	74.10
82.45	122.20	91.20
107.80	160.90	113.15
141.05	207.05	148.15
213.10	292.70	223.65
282.80	375.35	296.85
371.45	477.30	390.00
445.90	564.90	468.45
559.80	698.40	587.65

Add 50% to bronze pricing, for cast brass.

Roffe No. 515

ABCDEFGHIJKLMNOPQRSTUVWXYZ 1 2 3 4 5 6 7 8 9 0 &

DIMENSIONS				
HEIGHT	AVERAGE WIDTH	STROKE		DEPTH
3	2	9/32	9/16	
4	2-3/8	3/8	3/4	
5	3	15/32	15/16	
6	3-1/2	9/16	1-1/8	
8	4-3/4	3/4	1-1/2	
10	5-7/8	15/16	1-7/8	
12	7	1-1/8	2-1/4	
14	8-1/8	1-5/16	2-5/8	
16	10-1/2	1-1/2	3	

ALUMINUM FINISHES				
F-1 Satin Face, Matte Edge, Clear Lacquer	F-1B Buffed Face, Matte Edge, Clear Lacquer	F-4 Satin Face, Matte Edge, Clear Anodized	F-3 Painted Finish F-4A Satin Face, Filed Edge, Clear Anodized	F-6 Bronze or Black Duranodic; Gold Anodized
F-2 Satin Face, Painted Edge	F-2B Buffed Face, Painted Edge			
18.85	38.35	21.10	24.05	32.35
26.90	52.80	29.65	34.75	48.45
30.75	63.45	33.85	39.50	55.25
36.15	75.30	40.25	46.95	76.75
50.30	102.65	56.00	65.60	91.95
71.60	136.95	72.10	83.75	118.25
81.30	159.60	94.35	115.05	161.55
102.75	201.55	113.95	133.15	187.05
149.65	262.55	166.10	203.25	278.70

BRONZE FINISHES		
F-7 Satin Face, Oxidized Edge, Clear Lacquer	F-7B Buffed Face, Oxidized Edge, Clear Lacquer	F-10 (US-10B) Antique, Oil Rubbed Satin Face, Matte Edge, Clear Lacquer
F-8 Oxidized Face, & Edge Clear Lacquer		
44.50	64.50	46.45
63.50	89.90	66.40
69.10	100.70	72.25
82.30	120.20	86.00
115.30	165.75	120.60
147.95	210.85	154.65
255.45	331.15	268.30
290.45	378.65	304.85
443.05	544.05	465.40

Add 50% to bronze pricing, for cast brass.

Condensed Classic No. 516

ABCDEFGHIJKLMNOPQRSTUVWXYZ 1 2 3 4 5 6 7 8 9 0 &

DIMENSIONS				
HEIGHT	AVERAGE WIDTH	STROKE		DEPTH
3	2-1/8	9/16	7/32	3/8
4	2-5/8	3/4	1/4	3/8
6	3-3/4	7/8	3/8	3/8
8	5	1-1/4	1/2	1/2
10	6-1/4	1-5/8	5/8	5/8
12	7-1/2	1-3/4	3/4	3/4
14	8-3/4	2-1/8	7/8	1
16	10	2-1/2	1	1
18	11-1/2	2-5/8	1-1/8	1

ALUMINUM FINISHES				
F-1 Satin Face, Matte Edge, Clear Lacquer	F-1B Buffed Face, Matte Edge, Clear Lacquer	F-4 Satin Face, Matte Edge, Clear Anodized	F-3 Painted Finish F-4A Satin Face, Filed Edge, Clear Anodized	F-6 Bronze or Black Duranodic; Gold Anodized
F-2 Satin Face, Painted Edge	F-2B Buffed Face, Painted Edge			
15.00	33.70	16.05	19.20	27.10
18.50	43.35	19.75	23.95	33.60
24.95	62.25	26.45	32.15	45.05
33.10	82.80	35.10	44.25	58.15
43.95	106.05	46.70	56.70	80.15
53.25	127.55	56.65	69.00	98.15
59.45	153.60	63.65	77.80	108.50
74.70	182.20	79.10	96.70	135.90
96.70	249.65	103.05	125.55	176.35

BRONZE FINISHES		
F-7 Satin Face, Oxidized Edge, Clear Lacquer	F-7B Buffed Face, Oxidized Edge, Clear Lacquer	F-10 (US-10B) Antique, Oil Rubbed Satin Face, Matte Edge, Clear Lacquer
F-8 Oxidized Face, & Edge Clear Lacquer		
35.45	57.30	39.80
41.95	65.85	43.90
56.45	92.40	58.85
75.45	123.45	78.50
100.20	160.30	104.65
153.30	225.30	160.90
169.30	253.35	177.85
210.70	306.75	221.10
274.00	381.95	287.50

Add 50% to bronze pricing, for cast brass.

Condensed Futura No. 517

A B C D E F G H I J K L M N O P Q R S T U V W X Y Z 1 2 3 4 5 6 7 8 9 0 &

DIMENSIONS			
HEIGHT	AVERAGE WIDTH	STROKE	DEPTH
4	1-3/4	9/16	3/8
6	2-3/4	13/16	3/8
8	3-1/2	1-1/8	1/2
10	5	1-3/8	5/8
12	5-1/2	1-5/8	3/4
14	7	2	1
16	7-1/2	2-1/4	1

ALUMINUM FINISHES				
F-1 Satin Face, Matte Edge, Clear Lacquer	F-1B Buffed Face, Matte Edge, Clear Lacquer	F-4 Satin Face, Matte Edge, Clear Anodized	F-3 Painted Finish F-4A Satin Face, Filed Edge, Clear Anodized	F-6 Bronze or Black Duranodic; Gold Anodized
F-2 Satin Face, Painted Edge	F-2B Buffed Face, Painted Edge			
11.95	36.60	13.40	20.25	28.55
22.25	59.35	24.45	28.70	40.35
29.65	79.25	32.75	38.05	59.95
43.65	95.20	36.35	48.40	57.05
41.55	118.15	48.70	56.70	80.30
59.45	146.55	66.40	77.55	108.55
67.05	174.70	74.55	89.35	122.00

BRONZE FINISHES		
F-7 Satin Face, Oxidized Edge, Clear Lacquer	F-7B Buffed Face, Oxidized Edge, Clear Lacquer	F-10 (US-10B) Antique, Oil Rubbed Satin Face, Matte Edge, Clear Lacquer
F-8 Oxidized Face, & Edge Clear Lacquer		
37.25	62.35	38.80
52.60	90.40	54.90
70.35	120.75	73.35
78.55	141.70	82.25
132.50	208.25	137.40
177.30	265.50	186.00
207.45	309.30	218.85

Add 50% to bronze pricing, for cast brass.

Clarendon Medium No. 518 (upper & lower case available)

A B C D E F G H I J K L M N O P Q R S T U V W X Y Z

a b c d e f g h i j k l m n o p q r s t u v w x y z 1 2 3 4 5 6 7 8 9 0 &

DIMENSIONS			
HEIGHT	AVERAGE WIDTH	STROKE	DEPTH
2	2	1/2 1/4	3/8
3	3	3/4 3/8	3/8
4	4	1 1/2 1/2	1/2
6	6	1-1/2 3/4	1/2
8	8	2 1	3/4
10	10	2-1/2 1-1/4	3/4
12	12	3 1-3/4	1
14	14	3-1/8 1-7/8	1
16	16	3-1/2 2 1-1/4	

ALUMINUM FINISHES				
F-1 Satin Face, Matte Edge, Clear Lacquer	F-1B Buffed Face, Matte Edge, Clear Lacquer	F-4 Satin Face, Matte Edge, Clear Anodized	F-3 Painted Finish F-4A Satin Face, Filed Edge, Clear Anodized	F-6 Bronze or Black Duranodic; Gold Anodized
F-2 Satin Face, Painted Edge	F-2B Buffed Face, Painted Edge			
17.60	29.95	18.75	21.10	29.35
20.25	38.85	21.50	24.00	33.45
26.65	51.60	28.35	32.40	44.95
33.25	70.45	35.65	41.60	60.55
42.25	91.95	44.95	52.60	77.00
55.45	117.35	59.10	72.30	101.15
66.55	141.00	70.75	86.45	116.65
85.60	179.75	91.55	107.50	150.55
98.50	206.35	105.85	124.30	174.15

BRONZE FINISHES		
F-7 Satin Face, Oxidized Edge, Clear Lacquer	F-7B Buffed Face, Oxidized Edge, Clear Lacquer	F-10 (US-10B) Antique, Oil Rubbed Satin Face, Matte Edge, Clear Lacquer
F-8 Oxidized Face, & Edge Clear Lacquer		
37.50	50.25	39.15
43.30	62.10	45.15
57.40	82.65	60.00
80.80	118.80	84.60
102.40	152.85	106.90
134.25	197.15	140.30
201.75	277.50	212.10
246.10	334.35	258.45
284.65	385.45	298.65

Add 50% to bronze pricing, for cast brass.

Clarendon Medium (Outline Face) No. 525 (capitals only)

A B C D E F G H I J K L M N O P Q R S T U V W X Y Z 1 2 3 4 5 6 7 8 9 0 &

DIMENSIONS			
HEIGHT	AVERAGE WIDTH	STROKE	DEPTH
2	2	1/2 1/4	3/8
3	3	3/4 3/8	3/8
4	4	1 1/2	3/8
5	5	1-1/4 11/16	3/8
6	6	1-1/2 3/4	1/2
8	8	2 1	3/4
10	10	2-1/2 1-1/4	3/4
12	12	3 1-3/4	7/8
14	14	3-1/8 1-7/8	1
16	16	3-1/2 2 1-1/4	

ALUMINUM FINISHES				
F-1 Satin Face, Matte Edge, Clear Lacquer	F-1B Buffed Face, Matte Edge, Clear Lacquer	F-4 Satin Face, Matte Edge, Clear Anodized	F-3 Painted Finish F-4A Satin Face, Filed Edge, Clear Anodized	F-6 Bronze or Black Duranodic; Gold Anodized
F-2 Satin Face, Painted Edge	F-2B Buffed Face, Painted Edge			
20.50	32.95	21.80	24.90	33.30
23.65	42.40	25.20	28.45	38.30
31.35	56.20	33.60	37.65	50.75
35.60	66.60	37.75	42.50	56.40
39.30	76.60	42.15	47.20	62.95
49.55	98.15	53.15	64.90	86.85
65.55	127.55	69.85	85.95	114.55
78.30	152.60	83.75	102.15	137.05
101.15	195.25	107.95	126.50	169.90
117.30	224.90	125.15	146.50	196.60

BRONZE FINISHES		
F-7 Satin Face, Oxidized Edge, Clear Lacquer	F-7B Buffed Face, Oxidized Edge, Clear Lacquer	F-10 (US-10B) Antique, Oil Rubbed Satin Face, Matte Edge, Clear Lacquer
F-8 Oxidized Face, & Edge Clear Lacquer		
42.15	54.75	44.05
48.25	67.40	50.50
63.15	88.20	67.80
72.65	104.10	75.60
82.10	119.65	85.60
111.65	162.15	116.35
142.10	205.15	148.50
238.45	314.10	250.30
289.70	378.00	304.25
335.55	436.45	352.40

Add 50% to bronze pricing, for cast brass.

Microgramma Bold Extended No. 519

A B C D E F G H I J K L M N O P Q R S T U V W X Y Z
1 2 3 4 5 6 7 8 9 0 &

DIMENSIONS			
HEIGHT	AVERAGE WIDTH	STROKE	DEPTH
2	2	9/16	1/4
3	3	7/8	3/8
4	6	1	1/2
6	8-1/2	1-1/2	5/8
8	11	2	3/4
10	14	2-3/4	7/8
12	16	3	1

ALUMINUM FINISHES				
F-1 Satin Face, Matte Edge, Clear Lacquer	F-1B Buffed Face, Matte Edge, Clear Lacquer	F-4 Satin Face, Matte Edge, Clear Anodized	F-3 Painted Finish F-4A Satin Face, Filed Edge, Clear Anodized	F-6 Bronze or Black Duranodic; Gold Anodized
F-2 Satin Face, Painted Edge	F-2B Buffed Face, Painted Edge			
15.75	28.10	17.10	17.95	25.10
18.50	37.15	20.05	21.25	29.65
26.20	51.00	28.45	31.10	43.65
34.30	71.55	37.15	43.15	60.80
44.80	94.45	48.90	56.70	79.05
60.75	122.70	67.90	77.40	108.05
70.45	145.05	78.25	86.90	121.60

BRONZE FINISHES		
F-7 Satin Face, Oxidized Edge, Clear Lacquer	F-7B Buffed Face, Oxidized Edge, Clear Lacquer	F-10 (US-10B) Antique, Oil Rubbed Satin Face, Matte Edge, Clear Lacquer
F-8 Oxidized Face, & Edge Clear Lacquer		
34.60	47.15	36.20
40.60	59.45	42.50
60.00	85.20	62.85
81.00	118.90	84.80
106.75	157.15	111.65
145.45	208.25	151.75
202.85	278.45	212.90

Add 50% to bronze pricing, for cast brass.

Helvetica Bold Extended No. 520

A B C D E F G H I J K L M N O P Q R S T U V W X Y Z
1 2 3 4 5 6 7 8 9 0 &

DIMENSIONS			
HEIGHT	AVERAGE WIDTH	STROKE	DEPTH
4	5-3/4	1-11/16 13/16	1/2
6	8-1/2	2-1/4 1-5/16	3/4
9	12-3/4	3-1/4 1-7/8	1
12	17	4-1/2 2-3/4	1-1/4
15	21	6-1/4 3-1/8	1-1/2

ALUMINUM FINISHES				
F-1 Satin Face, Matte Edge, Clear Lacquer	F-1B Buffed Face, Matte Edge, Clear Lacquer	F-4 Satin Face, Matte Edge, Clear Anodized	F-3 Painted Finish F-4A Satin Face, Filed Edge, Clear Anodized	F-6 Bronze or Black Duranodic; Gold Anodized
F-2 Satin Face, Painted Edge	F-2B Buffed Face, Painted Edge			
27.10	51.95	28.65	32.75	45.80
36.75	74.10	39.45	44.35	62.05
65.65	121.55	70.05	78.70	110.70
88.60	163.15	98.45	120.60	149.65
110.00	211.15	127.00	172.50	209.35

BRONZE FINISHES		
F-7 Satin Face, Oxidized Edge, Clear Lacquer	F-7B Buffed Face, Oxidized Edge, Clear Lacquer	F-10 (US-10B) Antique, Oil Rubbed Satin Face, Matte Edge, Clear Lacquer
F-8 Oxidized Face, & Edge Clear Lacquer		
58.30	83.60	60.85
83.70	121.45	87.45
116.15	172.90	121.30
281.35	356.95	295.30
395.15	489.80	415.00

Add 50% to bronze pricing, for cast brass.

Helvetica Medium No. 521 (upper and lower case available)

A B C D E F G H I J K L M N O P Q R S T U V W X Y Z 1 2 3 4 5 6 7 8 9 0 &
abcdefghijklmnopqrstuvwxyz

DIMENSIONS			
HEIGHT	AVERAGE WIDTH	STROKE	DEPTH
2	1-3/4	3/8	3/8
3	2-5/8	9/16	3/8
4	3-1/2	3/4	3/8
5	4-3/8	1	3/8
6	5-1/4	1-1/8	1/2
8	7	1-1/2	5/8
9	8	1-5/8	5/8
10	8-3/4	1-3/4	3/4
12	10-1/2	2-1/4	1
14	12-1/4	2-5/8	1
15	13-1/4	2-7/8	1
16	14	3	1-1/4
18	15-3/4	3-1/4	1-1/2
24	21	4-1/2	2

ALUMINUM FINISHES				
F-1 Satin Face, Matte Edge, Clear Lacquer	F-1B Buffed Face, Matte Edge, Clear Lacquer	F-4 Satin Face, Matte Edge, Clear Anodized	F-3 Painted Finish F-4A Satin Face, Filed Edge, Clear Anodized	F-6 Bronze or Black Duranodic; Gold Anodized
F-2 Satin Face, Painted Edge	F-2B Buffed Face, Painted Edge			
17.05	29.55	19.00	20.45	28.70
18.15	36.60	20.05	21.70	30.80
19.35	44.25	20.85	23.40	32.75
22.85	53.95	24.55	27.75	39.00
26.40	63.65	28.65	31.95	45.00
36.05	85.60	39.35	44.25	61.20
43.20	99.10	46.85	52.20	73.05
50.25	112.35	54.00	60.35	85.80
57.35	131.75	61.75	69.00	98.05
73.30	167.45	81.25	90.85	128.25
85.60	186.75	93.60	103.60	147.20
98.80	206.40	105.35	116.80	166.40
125.35	278.25	133.15	145.65	212.00
182.50	332.60	196.55	221.15	298.00

BRONZE FINISHES		
F-7 Satin Face, Oxidized Edge, Clear Lacquer	F-7B Buffed Face, Oxidized Edge, Clear Lacquer	F-10 (US-10B) Antique, Oil Rubbed Satin Face, Matte Edge, Clear Lacquer
F-8 Oxidized Face, & Edge Clear Lacquer		
40.05	52.60	41.70
42.20	61.25	44.05
44.55	69.85	46.75
53.20	84.75	55.35
61.50	99.20	63.90
83.90	134.30	87.60
97.50	154.10	101.95
111.30	174.30	116.95
160.95	236.60	168.95
207.65	296.00	217.90
237.45	332.50	249.30
267.35	368.25	280.80
333.60	447.05	350.25
472.80	616.75	251.20

Add 50% to bronze pricing, for cast brass.

Helvetica Regular No. 524 (upper and lower case available)

ABCDEFGHIJKLMNOPQRSTUVWXYZ & 1234567890
 abcdefghijklmnopqrstuvwxyz

DIMENSIONS			
HEIGHT	AVERAGE WIDTH	STROKE	DEPTH
2	1-3/4	5/16	3/8
3	2-5/8	7/16	3/8
4	3-1/2	9/16	3/8
6	5-1/4	7/8	1/2
8	7	1-1/8	5/8
10	8-3/4	1-7/16	3/4
12	10-1/2	1-3/4	1
14	12-1/4	2	1
16	14	2-5/16	1-1/4
18	15-3/4	2-9/16	1-1/2

ALUMINUM FINISHES				
F-1 Satin Face, Matte Edge, Clear Lacquer	F-1B Buffed Face, Matte Edge, Clear Lacquer	F-4 Satin Face, Matte Edge, Clear Anodized	F-3 Painted Finish F-4A Satin Face, Filed Edge, Clear Anodized	F-6 Bronze or Black Duranodic; Gold Anodized
F-2 Satin Face, Painted Edge	F-2B Buffed Face, Painted Edge			
17.05	29.55	19.00	20.45	28.70
18.15	36.60	20.05	21.65	30.80
19.35	44.25	20.85	23.40	32.75
26.40	63.65	28.30	31.95	45.00
36.05	85.60	39.35	44.25	61.20
50.25	112.35	54.00	60.35	85.80
57.35	131.85	61.75	69.00	98.05
73.30	167.45	81.25	90.85	128.25
98.80	206.40	105.35	116.80	166.40
125.35	278.25	133.25	133.25	211.50

BRONZE FINISHES		
F-7 Satin Face, Oxidized Edge, Clear Lacquer	F-7B Buffed Face, Oxidized Edge, Clear Lacquer	F-10 (US-10B) Antique, Oil Rubbed Satin Face, Matte Edge, Clear Lacquer
F-8 Oxidized Face, & Edge Clear Lacquer		
40.05	52.60	41.80
42.20	61.25	44.05
44.55	69.85	46.75
61.50	99.20	63.90
83.85	134.30	87.60
111.30	174.30	116.20
160.95	236.60	168.95
207.65	296.00	217.90
267.35	368.25	280.80
333.60	447.05	350.25

Add 50% to bronze pricing, for cast brass.

Helvetica Bold No. 531 (upper and lower case available)

ABCDEFGHIJKLMNOPQRSTUVWXYZ &
 abcdefghijklmnopqrstuvwxyz 1 2 3 4 5 6 7 8 9 0

DIMENSIONS			
HEIGHT	AVERAGE WIDTH	STROKE	DEPTH
3	2-5/8	11/16	3/8
4	3-1/2	1-5/16	3/8
6	5-1/4	1-7/8	1/2
8	7	2-1/2	5/8
10	8-3/4	3-1/8	3/4
12	10-1/2	3-3/4	1
14	12-1/4	4-3/8	1
16	14	5	1-1/4
18	15-3/4	5-5/8	1-1/2

ALUMINUM FINISHES				
F-1 Satin Face, Matte Edge, Clear Lacquer	F-1B Buffed Face, Matte Edge, Clear Lacquer	F-4 Satin Face, Matte Edge, Clear Anodized	F-3 Painted Finish F-4A Satin Face, Filed Edge, Clear Anodized	F-6 Bronze or Black Duranodic; Gold Anodized
F-2 Satin Face, Painted Edge	F-2B Buffed Face, Painted Edge			
18.15	36.60	20.05	21.65	30.80
19.35	44.25	20.85	23.40	32.75
26.40	63.65	28.65	31.95	45.00
36.05	85.60	39.35	44.25	61.20
50.25	112.35	54.00	60.35	85.80
57.35	131.85	61.75	69.00	98.05
73.30	167.45	81.25	90.85	128.25
98.80	206.40	105.35	116.80	166.40
208.70	278.25	133.25	146.15	211.50

BRONZE FINISHES		
F-7 Satin Face, Oxidized Edge, Clear Lacquer	F-7B Buffed Face, Oxidized Edge, Clear Lacquer	F-10 (US-10B) Antique, Oil Rubbed Satin Face, Matte Edge, Clear Lacquer
F-8 Oxidized Face, & Edge Clear Lacquer		
42.20	61.25	44.05
44.55	69.85	46.75
61.50	99.20	63.85
83.85	134.30	87.60
111.30	174.30	116.20
160.95	236.60	168.95
207.65	269.00	217.90
267.35	368.25	280.80
333.60	447.05	350.25

Add 50% to bronze pricing, for cast brass.

Friz Quadrata No. 526 (upper and lower case available)

ABCDEFGHIJKLMNOPQRSTUVWXYZ & 1 2 3 4 5 6 7 8 9 0
 abcdefghijklmnopqrstuvwxyz

DIMENSIONS			
HEIGHT	AVERAGE WIDTH	STROKE	DEPTH
2	1-3/4	5/16	3/8
3	2-5/8	7/16	3/8
4	3-1/2	9/16	3/8
6	5-1/4	13/16	1/2
8	7	1-1/8	5/8
10	8-3/4	1-3/8	3/4
12	10-1/2	1-5/8	1
14	12-1/4	1-7/8	1
16	14	2-3/16	1-1/4
18	15-3/4	2-1/2	1-1/2

ALUMINUM FINISHES				
F-1 Satin Face, Matte Edge, Clear Lacquer	F-1B Buffed Face, Matte Edge, Clear Lacquer	F-4 Satin Face, Matte Edge, Clear Anodized	F-3 Painted Finish F-4A Satin Face, Filed Edge, Clear Anodized	F-6 Bronze or Black Duranodic; Gold Anodized
F-2 Satin Face, Painted Edge	F-2B Buffed Face, Painted Edge			
14.50	26.80	16.30	19.70	24.70
15.95	34.85	18.00	20.60	27.85
17.75	42.55	19.70	22.50	30.85
26.00	63.35	29.65	32.65	42.15
34.15	83.65	37.05	40.70	54.35
45.00	107.25	48.10	53.65	71.65
61.05	129.00	64.90	71.10	96.40
80.00	182.45	85.30	91.65	117.50
103.10	211.20	106.95	78.60	139.50
115.30	236.55	128.45	151.85	203.70

BRONZE FINISHES		
F-7 Satin Face, Oxidized Edge, Clear Lacquer	F-7B Buffed Face, Oxidized Edge, Clear Lacquer	F-10 (US-10B) Antique, Oil Rubbed Satin Face, Matte Edge, Clear Lacquer
F-8 Oxidized Face, & Edge Clear Lacquer		
35.40	48.65	36.95
38.05	56.90	39.80
39.90	65.10	41.75
63.15	100.75	65.85
86.65	137.10	90.50
101.65	165.00	106.50
144.30	219.95	150.80
209.70	297.95	220.15
263.65	364.55	276.75
348.05	461.45	365.30

Add 50% to bronze pricing, for cast brass.

Optima No. 530

A B C D E F G H I J K L M N O P Q R S T U V W X Y Z 1 2 3 4 5 6 7 8 9 0 &

DIMENSIONS				
HEIGHT	AVERAGE WIDTH	STROKE		DEPTH
2	1-3/4	1/4	1/8	1/4
3	2-5/8	3/8	3/16	3/8
4	3-1/2	1/2	1/4	3/8
6	5-1/4	3/4	3/8	3/8
8	7	1	1/2	1/2
10	8-3/4	1-1/4	5/8	1/2
12	10-1/2	1-1/2	3/4	1/2
14	12-1/4	1-3/4	7/8	3/4
16	14	2	1	1

ALUMINUM FINISHES				
F-1 Satin Face, Matte Edge, Clear Lacquer	F-1B Buffed Face, Matte Edge, Clear Lacquer	F-4 Satin Face, Matte Edge, Clear Anodized	F-3 Painted Finish F-4A Satin Face, Filed Edge, Clear Anodized	F-6 Bronze or Black Duranodic; Gold Anodized
F-2 Satin Face, Painted Edge	F-2B Buffed Face, Painted Edge			
13.80	26.20	15.75	18.85	23.40
15.00	33.80	16.95	19.70	33.05
16.80	41.75	18.85	21.50	29.30
24.90	62.10	28.20	31.10	40.10
32.40	82.10	35.30	38.95	51.75
42.80	104.95	45.85	51.35	67.75
58.20	132.75	61.75	67.70	91.90
77.55	171.70	81.25	87.50	112.05
98.25	205.95	101.85	109.80	132.85

BRONZE FINISHES		
F-7 Satin Face, Oxidized Edge, Clear Lacquer	F-7B Buffed Face, Oxidized Edge, Clear Lacquer	F-10 (US-10B) Antique, Oil Rubbed Satin Face, Matte Edge, Clear Lacquer
F-8 Oxidized Face, & Edge Clear Lacquer		
33.90	46.40	35.30
36.00	54.90	37.75
38.05	63.25	39.80
59.85	97.90	62.75
82.35	132.85	86.35
96.90	160.00	101.30
137.30	213.00	143.65
200.15	288.40	210.25
251.35	351.60	263.80

Add 50% to bronze pricing, for cast brass.

Palatino No. 527 (upper & lower case available)

A B C D E F G H I J K L M N O P Q R S T U V W X Y Z & 1 2 3 4 5 6 7 8 9 0
a b c d e f g h i j k l m n o p q r s t u v w x y z

DIMENSIONS				
HEIGHT	AVERAGE WIDTH	STROKE		DEPTH
2	2-1/8	1/4	1/8	3/8
3	3-3/16	7/16	3/16	3/8
4	4-1/4	1/2	1/4	3/8
6	6-3/8	7/8	3/8	1/2
8	8-1/2	1-1/16	1/2	3/4
10	10-5/8	1-3/8	5/8	1
12	12-3/4	1-5/8	3/4	1
14	14-7/8	1-7/8	1	1
16	17	2-1/8	1	1
18	19-1/8	2-7/16	1-1/8	1-1/2

ALUMINUM FINISHES				
F-1 Satin Face, Matte Edge, Clear Lacquer	F-1B Buffed Face, Matte Edge, Clear Lacquer	F-4 Satin Face, Matte Edge, Clear Anodized	F-3 Painted Finish F-4A Satin Face, Filed Edge, Clear Anodized	F-6 Bronze or Black Duranodic; Gold Anodized
F-2 Satin Face, Painted Edge	F-2B Buffed Face, Painted Edge			
11.20	23.95	11.70	14.20	19.35
16.65	35.20	18.00	20.35	28.45
20.40	45.00	22.40	27.45	35.25
28.70	64.75	28.70	34.05	47.95
36.50	86.20	37.95	44.90	63.25
48.05	110.25	50.90	59.95	84.00
60.55	135.15	65.20	72.35	101.30
70.30	163.90	75.35	81.00	121.90
90.85	198.45	94.00	101.45	142.25
118.30	271.40	122.10	131.60	185.10

BRONZE FINISHES		
F-7 Satin Face, Oxidized Edge, Clear Lacquer	F-7B Buffed Face, Oxidized Edge, Clear Lacquer	F-10 (US-10B) Antique, Oil Rubbed Satin Face, Matte Edge, Clear Lacquer
F-8 Oxidized Face, & Edge Clear Lacquer		
28.80	41.55	30.05
41.95	60.80	43.70
55.25	80.55	57.65
71.40	108.95	74.25
94.15	144.50	98.40
125.15	188.30	130.55
168.55	244.25	176.85
185.95	274.20	195.20
231.40	332.35	243.25
300.85	414.40	315.90

Add 50% to bronze pricing, for cast brass.

Times Roman No. 528 (upper & lower case available)

A B C D E F G H I J K L M N O P Q R S T U V W X Y Z 1 2 3 4 5 6 7 8 9 0 &
a b c d e f g h i j k l m n o p q r s t u v w x y z

DIMENSIONS				
HEIGHT	AVERAGE WIDTH	STROKE		DEPTH
2	1-7/8	5/16	1/8	3/8
3	2-7/8	1/2	3/16	3/8
4	3-3/4	5/8	1/4	3/8
6	5-3/4	1	3/8	1/2
8	7-1/2	1-1/4	1/2	3/4
10	9-1/2	1-1/2	5/8	3/4
12	11-1/2	2	3/4	1
14	13-1/2	2-1/4	7/8	1
16	15	2-1/2	1	1
18	17-1/4	3	1-1/8	1-1/2

ALUMINUM FINISHES				
F-1 Satin Face, Matte Edge, Clear Lacquer	F-1B Buffed Face, Matte Edge, Clear Lacquer	F-4 Satin Face, Matte Edge, Clear Anodized	F-3 Painted Finish F-4A Satin Face, Filed Edge, Clear Anodized	F-6 Bronze or Black Duranodic; Gold Anodized
F-2 Satin Face, Painted Edge	F-2B Buffed Face, Painted Edge			
10.85	23.50	11.50	13.80	19.20
16.40	35.20	17.85	20.25	28.30
20.25	45.15	22.25	27.40	35.20
27.40	65.20	28.60	34.05	48.15
36.50	86.60	38.05	45.05	65.00
48.15	110.85	51.95	60.25	84.35
60.80	136.00	65.35	72.70	101.95
70.85	166.05	75.85	82.00	122.65
91.55	200.10	94.65	105.50	143.30
119.20	273.75	123.10	132.65	186.60

BRONZE FINISHES		
F-7 Satin Face, Oxidized Edge, Clear Lacquer	F-7B Buffed Face, Oxidized Edge, Clear Lacquer	F-10 (US-10B) Antique, Oil Rubbed Satin Face, Matte Edge, Clear Lacquer
F-8 Oxidized Face, & Edge Clear Lacquer		
28.75	41.50	30.05
42.00	60.90	43.75
55.45	81.00	58.05
71.40	109.55	74.65
94.60	145.70	98.95
125.90	189.50	131.55
169.80	276.70	178.20
187.60	276.70	196.80
233.45	335.25	245.05
303.70	418.15	318.75

Add 50% to bronze pricing, for cast brass.

Times Bold No. 532 (upper & lower case available)

**A B C D E F G H I J K L M N O P Q R S T U V W X Y Z 1 2 3 4 5 6 7 8 9 0 &
a b c d e f g h i j k l m n o p q r s t u v w x y z**

DIMENSIONS				
HEIGHT	AVERAGE WIDTH	STROKE		DEPTH
3	2-7/8	11/16	1/8	3/8
4	3-3/4	15/16	3/16	3/8
6	5-3/4	1-1/2	3/8	1/2
8	7-1/2	1-7/8	1/2	3/4
10	9-1/2	2-3/8	5/8	3/4
12	11-1/2	2-7/8	3/4	1
14	13-1/2	3-3/8	15/16	1
16	15	3-7/8	1-1/8	1
18	17-1/4	4	1-1/4	1-1/2

ALUMINUM FINISHES				
F-1 Satin Face, Matte Edge, Clear Lacquer	F-1B Buffed Face, Matte Edge, Clear Lacquer	F-4 Satin Face, Matte Edge, Clear Anodized	F-3 Painted Finish F-4A Satin Face, Filed Edge, Clear Anodized	F-6 Bronze or Black Duranodic; Gold Anodized
F-2 Satin Face, Painted Edge	F-2B Buffed Face, Painted Edge			
16.40	35.20	17.85	20.25	28.30
20.25	45.15	20.95	27.40	35.20
27.40	65.20	28.60	34.05	48.15
36.50	86.60	38.05	45.05	65.00
48.15	110.90	51.95	60.25	84.35
60.80	136.00	65.35	72.70	101.95
70.85	166.05	75.90	82.00	122.65
91.55	200.10	94.65	105.50	143.30
119.20	273.75	123.10	132.65	186.60

BRONZE FINISHES		
F-7 Satin Face, Oxidized Edge, Clear Lacquer	F-7B Buffed Face, Oxidized Edge, Clear Lacquer	F-10 (US-10B) Antique, Oil Rubbed Satin Face, Matte Edge, Clear Lacquer
F-8 Oxidized Face, & Edge Clear Lacquer		
41.95	60.90	43.75
55.45	81.00	58.05
71.40	109.55	74.65
94.60	145.70	98.95
125.95	189.50	131.55
169.80	246.30	178.20
187.60	276.70	196.80
233.45	335.25	245.05
303.70	418.15	318.75

Add 50% to bronze pricing, for cast brass.

Optima Semi-Bold No. 533

**A B C D E F G H I J K L M N O P Q R S T U V W X Y Z 1 2 3 4 5 6 7 8 9 0 &
a b c d e f g h i j k l m n o p q r s t u v w x y z**

DIMENSIONS				
HEIGHT	AVERAGE WIDTH	STROKE		DEPTH
3	2-5/8	7/8	7/16	3/8
4	3-1/2	1-1/8	5/8	3/8
6	5-1/4	1-3/4	15/16	1/2
8	7	2-5/16	1-1/4	5/8
10	8-3/4	2-7/8	1-1/2	3/4
12	10-1/2	3-7/16	1-7/8	1
14	12-1/4	4-1/8	2-3/16	1
16	14	4-9/16	2-7/16	1-1/2
18	16-1/2	5-13/16	2-13/16	1-1/2

ALUMINUM FINISHES				
F-1 Satin Face, Matte Edge, Clear Lacquer	F-1B Buffed Face, Matte Edge, Clear Lacquer	F-4 Satin Face, Matte Edge, Clear Anodized	F-3 Painted Finish F-4A Satin Face, Filed Edge, Clear Anodized	F-6 Bronze or Black Duranodic; Gold Anodized
F-2 Satin Face, Painted Edge	F-2B Buffed Face, Painted Edge			
15.05	33.80	16.95	19.70	26.45
16.80	41.75	18.90	21.50	29.30
28.35	62.10	28.20	31.10	40.10
32.40	82.05	35.30	38.95	51.75
42.80	104.95	45.85	51.35	68.05
58.20	132.75	61.75	67.70	91.90
77.55	171.70	81.25	87.50	112.05
98.25	205.95	101.85	109.80	132.85
125.35	278.25	133.25	146.15	211.50

BRONZE FINISHES		
F-7 Satin Face, Oxidized Edge, Clear Lacquer	F-7B Buffed Face, Oxidized Edge, Clear Lacquer	F-10 (US-10B) Antique, Oil Rubbed Satin Face, Matte Edge, Clear Lacquer
F-8 Oxidized Face, & Edge Clear Lacquer		
36.20	54.90	37.75
38.05	63.25	39.80
59.85	97.90	62.75
82.35	132.85	86.35
96.90	160.00	101.30
137.30	213.00	143.65
200.15	288.40	210.25
251.35	351.60	263.80
333.60	447.05	322.75

Add 50% to bronze pricing, for cast brass.

Garamond 534 (upper & lower case available)

**A B C D E F G H I J K L M N O P Q R S T U V W X Y Z 1 2 3 4 5 6 7 8 9 0 &
a b c d e f g h i j k l m n o p q r s t u v w x y z**

DIMENSIONS				
HEIGHT	AVERAGE WIDTH	STROKE		DEPTH
3	2-7/8	9/16	3/8	3/8
4	3-3/4	3/4	1/4	3/8
6	5-3/4	1-1/16	5/16	1/2
8	7-1/2	1-7/16	7/16	3/4
10	9-1/2	2-3/16	9/16	3/4
12	11-1/2	2-3/16	11/16	1
14	13-1/2	2-9/16	3/4	1
16	15	2-7/8	7/8	1
18	17-1/4	3-1/4	1	1-1/2

ALUMINUM FINISHES				
F-1 Satin Face, Matte Edge, Clear Lacquer	F-1B Buffed Face, Matte Edge, Clear Lacquer	F-4 Satin Face, Matte Edge, Clear Anodized	F-3 Painted Finish F-4A Satin Face, Filed Edge, Clear Anodized	F-6 Bronze or Black Duranodic; Gold Anodized
F-2 Satin Face, Painted Edge	F-2B Buffed Face, Painted Edge			
16.40	35.20	17.85	20.25	28.30
20.25	45.15	22.25	27.40	35.20
27.40	65.25	28.60	34.05	48.15
36.50	56.60	38.10	45.05	65.20
48.15	110.95	51.95	60.25	84.35
60.85	136.05	65.35	72.70	101.95
70.85	166.05	75.90	82.05	122.65
91.55	200.10	94.70	101.85	143.30
119.20	23.75	123.10	123.10	186.60

BRONZE FINISHES		
F-7 Satin Face, Oxidized Edge, Clear Lacquer	F-7B Buffed Face, Oxidized Edge, Clear Lacquer	F-10 (US-10B) Antique, Oil Rubbed Satin Face, Matte Edge, Clear Lacquer
F-8 Oxidized Face, & Edge Clear Lacquer		
41.95	60.90	43.75
55.45	81.00	58.05
71.40	109.55	74.65
94.60	145.70	98.95
125.90	189.50	131.55
169.80	246.30	178.20
187.60	276.70	196.80
233.45	335.25	245.05
303.70	418.15	318.75

Add 50% to bronze pricing, for cast brass.

Fabricated Stainless Mirror Face and Edges on Block Letters

HEIGHT (Inches)	LETTER DEPTH (Inches)			
	1/4	3/8 - 1/2	3/4	1
2"	19.65	21.60		
3"	23.65	25.95	28.55	
4"	27.45	30.20	33.25	36.50
5"	29.40	32.60	35.60	39.05
6"	31.70	34.85	44.10	42.15
8"	39.15	43.00	47.25	52.05
10"	48.95	53.80	59.15	64.90
12"	70.25	77.35	85.15	93.55
14"	101.20	111.20	120.10	134.65

HEIGHT (Inches)	LETTER DEPTH (Inches)			
	1/4	3/8 - 1/2	3/4	1
16"	121.10	133.10	146.40	161.00
18"	136.10	149.80	164.75	181.15
20"	159.20	174.95	192.60	211.85
22"	196.95	216.65	238.30	262.15
24"	229.15	252.10	277.20	304.90
26"	258.60	284.30	312.75	344.00
28"	278.45	306.20	336.80	370.55
30"	298.30	328.10	360.90	396.90

Letters are reverse channel fabricated letters. Stainless steel finishes available include mirror polished finish on face and edges or satin finish on face and edges. Add 30% for serif letters. Add 40% for titanium finish (gold). Contact factory for pricing on satin finish letters. Mountings can be done in any of Bell Co Inc standard mountings. Templates are available on request and at an additional charge.

Precision-Cut Letters

Aluminum

HEIGHT	1/8" THICK		3/16" THICK		1/4" THICK		3/8" THICK		1/2" THICK	
	BLOCK	SERIF	BLOCK	SERIF	BLOCK	SERIF	BLOCK	SERIF	BLOCK	SERIF
2"	9.90	14.40	12.10	15.90	14.10	18.15	20.45	26.40	27.15	31.70
3"	13.00	15.90	15.25	18.90	17.35	21.85	25.75	30.15	35.35	44.50
4"	15.90	19.60	17.35	21.25	21.85	25.75	30.15	33.95	45.25	55.65
5"	18.15	21.85	23.50	27.15	27.45	32.45	36.30	41.15	59.50	71.50
6"	22.70	26.90	27.50	31.70	33.55	37.60	43.45	47.50	66.30	79.80
7"	25.35	29.40	30.90	34.75	38.55	42.30	53.45	57.25	81.40	94.85
8"	29.40	33.15	36.30	39.85	46.75	52.40	64.50	67.00	99.35	112.95
9"	33.95	37.60	40.80	45.25	51.25	55.65	73.15	76.95	108.45	123.45
10"	37.00	41.45	46.75	50.55	55.45	61.10	82.80	86.65	112.95	128.00
11"	40.80	43.70	50.55	54.20	63.45	67.85	91.95	96.45	131.35	147.60
12"	48.25	52.80	57.25	61.05	75.30	79.80	100.70	109.95	158.10	173.05

Brass

2"	14.10	18.35	17.10	21.55	23.35	27.40	30.80	36.45	43.10	48.05
3"	17.45	22.50	22.50	26.55	29.90	35.70	39.80	43.10	51.65	57.20
4"	22.15	26.55	29.90	34.75	37.35	41.95	46.70	58.05	66.30	82.85
5"	31.85	35.70	39.80	39.20	49.70	53.90	73.10	84.55	87.80	102.70
6"	36.45	42.40	46.90	46.25	59.95	68.55	87.80	102.65	116.00	132.55
7"	42.40	49.75	55.25	57.95	72.90	79.60	92.75	107.75	129.15	144.45
8"	52.25	60.55	61.45	89.55	93.50	97.80	115.10	130.15	145.85	165.65
9"	63.80	72.90	83.70	102.65	104.30	119.30	137.55	155.70	173.90	198.75
10"	73.75	87.80	96.70	108.55	122.55	139.15	160.70	185.50	198.75	223.65
11"	85.45	99.40	111.25	124.65	140.00	159.20	188.00	217.00	240.10	277.35
12"	97.15	111.10	126.25	140.80	157.40	178.90	215.45	248.35	281.45	331.10

Bronze

2"	19.85	25.65	23.90	30.25	32.55	38.30	43.00	49.90	60.30	67.30
3"	24.40	31.40	31.40	37.25	41.80	49.85	55.70	60.30	73.15	80.00
4"	30.90	37.20	41.80	49.75	52.25	58.60	65.00	81.15	92.75	116.00
5"	42.35	49.85	55.75	67.75	69.65	75.40	102.20	123.05	118.25	143.75
6"	38.00	59.05	69.45	78.15	88.15	96.30	122.90	143.75	162.35	185.50
7"	59.10	69.65	77.25	102.20	110.45	111.30	129.80	150.75	180.70	204.10
8"	73.15	84.70	95.20	125.35	130.95	136.80	161.15	182.00	204.10	231.70
9"	89.35	102.20	117.20	143.75	146.05	166.90	192.50	218.05	243.50	278.25
10"	103.45	122.85	134.75	151.95	171.65	194.75	224.95	259.60	278.25	312.95
11"	119.40	139.15	151.15	174.05	197.05	222.65	266.60	312.50	324.50	382.60
12"	135.90	155.10	176.80	197.05	220.30	250.35	301.15	347.75	394.10	463.65

Cut metal plate letters are priced individually based on their longest dimension. Pricing is for our standard satin finish (satin polished faces, matte sandblasted edges and clear topcoat). Add \$.60 per inch for standard painted colors or \$2.00 per inch for mirror-buffed faces. Contact our sales staff for pricing on script or connected letters. Add 40% for color anodizing (black, gold, bronze.) Add 25% for clear anodizing.

Fabricated Aluminum Letters

Satin Face, Matte Edge or Painted Finish on Block Letters

HEIGHT (Inches)	LETTER DEPTH (Inches)			
	1	2	3	4
8"	103.80	103.80	116.30	
10"	121.00	121.00	126.30	
12"	131.70	131.70	138.35	155.55
14"	162.60	162.60	183.15	195.35
16"	172.85	172.85	200.65	212.60
18"	186.60	186.60	219.25	235.20
20"	216.00	216.00	259.10	272.90
24"	259.10	259.10	299.00	323.00

HEIGHT (Inches)	LETTER DEPTH (Inches)			
	1	2	3	4
30"	310.90	348.85	371.35	402.65
36"	359.25	392.10	438.60	473.20
42"	388.70	454.40	492.15	544.95
48"	577.70	611.35	673.50	725.35
54"		724.00	803.70	863.50
60"		842.75	932.55	998.25
66"			1082.55	1139.75
72"			1230.10	1283.20

Pricing is for block letter styles in either satin aluminum or painted finish using standard color. Letters should be priced by their longest dimension (height or width). Add 20% to above pricing for serif letters. Contact our sales staff for pricing on script or connected letters. Add 30% for color anodizing (bronze, gold or black) and 15% for clear anodizing.

Letter Mounting Accessories

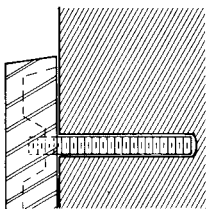

FM-4
Flush Mount with threaded studs set in adhesive

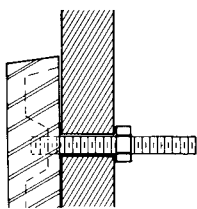

FM-4A
Same as FM-4 bolted from the rear (no adhesive)

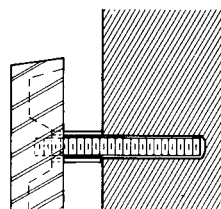

PM-1
Projected mount with collars and threaded studs set in adhesive

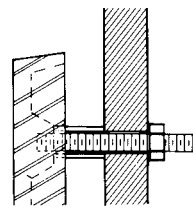

PM-1A
Same as PM-1 bolted from the rear (no adhesive)

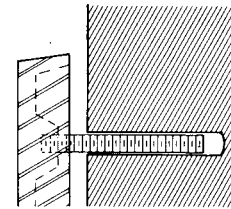

PM-1B
Same as PM-1 without collars set in adhesive

FM-4, FM-4A, PM-1, PM-1A, PM-1B (threaded stud mounting variations) No charge

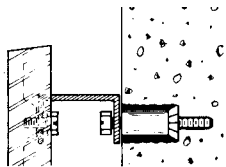

PM-2
Projected Mount with brackets (minimum projection 2")



BM-3
Free standing channel or bar mount

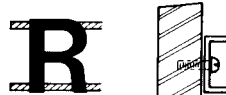

BM-3A
Double back bars or channels



BM-3B
Single back bar or channel

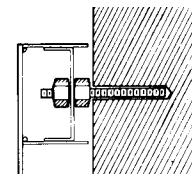

FABRICATED LETTERS
Adaptable to any stud-type mounting shown.

PM-2	Aluminum extension brackets, 2" to 4" projection	22.50 per letter
BM-3	Base mount, up to 8" letter (up to 1-1/2" aluminum bar or channel)	22.50 per letter
	Base mount, 9" to 18" letter (up to 3" aluminum channel)	22.50 per letter
	Base mount, 19" to 24" letter (up to 4" aluminum channel)	25.00 per letter
BM-3A	Double back mount, up to 8" letter (3/4" square aluminum channel)	27.00 per letter
	Double back mount, 9" to 12" letter (1-1/2" square aluminum channel)	27.00 per letter
BM-3B	Single back mount, up to 4" letter (1" aluminum bar)	22.50 per letter

Bars and channels are available in either natural aluminum or stock color painted finishes.

Desk and Door Plates



NUMBER	DESCRIPTION	BRONZE	ALUMINUM
244	10" x 3" Door Plate	111.63	81.35
245	10" x 2-1/4" Desk Plate (Easel Back)	135.00	102.35
246	Custom Etched Bronze Desk Plate	Contact Factory	
247	12" x 3" Desk Plate (Easel Back)	166.40	132.40

Add \$28.00 net for standard walnut bases. Contact factory for other sizes available.

Metal Signage Products

Standard Sign Types

Standard signs are available in 6" width and 8" height for signs requiring only pictograms. Copy signs with only letter and braille are available in 2" width and 10" length. Our standard sign types are available in many color combinations to accent any decorating or color scheme. Custom shapes, sizes, and colors are also available on a quoted basis.

Magnesium and zinc plates are finished in two colors to achieve an appropriate contrast. Aluminum and bronze plates are available with one color background and satin finished metal for the contrasting raised graphics, letters and braille.



ADA-7



ADA-8



ADA-9



ADA-10

SIGN TYPE	SIZE	MAGNESIUM/ZINC	ALUMINUM	BRONZE
Pictograms Only	6" x 6"	105.15	111.63	145.35
Pictograms W/Copy	6" x 8"	105.15	111.63	145.35
Copy Signs	2" x 10"	88.20	81.25	111.95

Artwork for Production

Bell Co Inc. will set the type and braille copy for standard signs. Custom signs will need to have full size camera ready artwork provided by customer. If you are not able to provide the artwork, our art department can produce the required art for most any design at a nominal charge.

Standard Colors

All plates are available with painted backgrounds in any of our standard colors. Magnesium and zinc plates will also have the raised surfaces painted in a contrasting color chosen from our standard colors.

Custom Colors will be \$75.00ea. per color.



ADA-1



ADA-2



ADA-3

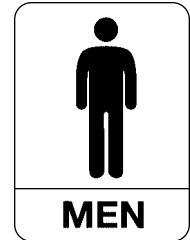

ADA-4



ADA-5

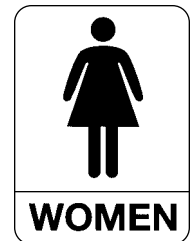

ADA-6

Ordering Information (order form on back cover.)

Additional Costs/Ordering Information

Artwork

In lieu of camera ready artwork you may provide an .EPS or .AI file for PC with your job. We cannot accept Macintosh disks. Contact the factory for any additional information you may need on electronic files and the requirements for production.

We can prepare artwork for logos or seals on your job if not available. You will need to contact the factory to get pricing information on this service along with time needs to complete your job.

Terms

Terms are net 30 days to established accounts. All other orders will require a 50% deposit with the balance C.O.D. If you wish to open an account, we will require four current credit references and a bank reference. Credit checks and approval take approximately four weeks.

Credit Cards

We now accept most major credit cards for payment. Contact our credit department for particular requirements.

Shipping

Unless specified we ship by the most economical means. All shipments are sent in perfect condition. Please open and inspect all packages immediately upon arrival. Any damages should be so noted when you sign the bill of lading. The delivering carrier should arrange for an inspection of any damaged product.

Returns

Should something need to be returned, you must have our authorization. You will need to enclose a cover letter with explanation and reason for return, along with action to be taken. Address your letter to the person you spoke with authorizing the return.

Minimum Charges & Additional Charges

Minimum Charges:

Standard letter order	\$60.00
Duranodic letter order	\$130.00
Cast plaques/plates	\$70.00

Custom Color Charge:

Custom color on plaques or letters \$100.00
(We will require a chip, formula or PMS number)

Drilling Templates:

Templates will be charged at twenty (20) cents per vertical inch per letter. (Example...Twenty six inch letters will be charged as 20 x 6" x .20 = \$24.00)(net). **Minimum charge \$14.00.**

Adhesive:

Silicon (one tube per 10 letters) \$5.00 per tube

Stainless Steel Hardware:

Add \$4.00 per letter for stainless steel studs (3")

Now Accepting Credits Cards – VISA, MasterCard and American Express

Prices and specifications are subject to change without prior notice.

Order Form

Printed in U.S.A.
© Copyright Bell Co Inc 2008

B I L L T O	COMPANY NAME	S H I P T O	
	ADDRESS		
	CITY, STATE, ZIP () / ()		
	TELEPHONE NUMBER & FAX NUMBER		
	P.O. Number		
		SHIP VIA: <input type="checkbox"/> UPS <input type="checkbox"/> AIR <input type="checkbox"/> OTHER RESIDENTIAL <input type="checkbox"/> YES <input type="checkbox"/> NO	

LETTER SPECIFICATION

CAST FABRICATED PRECISION CUT OTHER _____
 ALUMINUM BRONZE BRASS OTHER _____

LETTER STYLE	<input type="checkbox"/> UPPER CASE <input type="checkbox"/> UPPER/LOWER	HEIGHT	DEPTH
FINISH COLOR			
MOUNTING TYPE <input type="checkbox"/> FM-4 <input type="checkbox"/> FM4-A <input type="checkbox"/> PM-1 <input type="checkbox"/> PM-1A <input type="checkbox"/> BAR MOUNT <input type="checkbox"/> SPECIFY _____			
PROJECTION	TEMPLATE <input type="checkbox"/> YES <input type="checkbox"/> NO LENGTH	ADHESIVE <input type="checkbox"/> YES <input type="checkbox"/> NO	
APPROVAL DRAWINGS <input type="checkbox"/> YES <input type="checkbox"/> NO NO. OF COPIES _____	PATTERN/ARTWORK (IF NEEDED) <input type="checkbox"/> BELL CO TO PROVIDE @ ADDNL. COST <input type="checkbox"/> CUSTOMER TO PROVIDE		

TEXT	QTY/SIZE	UNIT COST	TOTAL
	/		
	/		
	/		
	/		
TEMPLATE LETTER HEIGHT X NO. OF LETTERS X 20¢ = COST (NET) (Minimum \$10.00)			
MOUNTING ADHESIVE 1 TUBE WILL BE PROVIDED PER 10 LETTERS APPROX.		\$4.00 ea.	
		TOTAL	

PLAQUE SPECIFICATION

ATTACH TEXT

CAST ETCHED
 ALUMINUM BRONZE BRASS OTHER _____

LETTER STYLE	TEXTURE
BORDER	FINISH
SIZE	MOUNTING TYPE <input type="checkbox"/> NO. 1 <input type="checkbox"/> NO. 2 <input type="checkbox"/> NO. 3 <input type="checkbox"/> NO. 4 <input type="checkbox"/> NO. 5
APPROVAL DRAWINGS <input type="checkbox"/> YES <input type="checkbox"/> NO NO. OF COPIES _____	PATTERN/ARTWORK (IF NEEDED) <input type="checkbox"/> BELL CO TO PROVIDE @ ADDNL. COST <input type="checkbox"/> CUSTOMER TO PROVIDE

SIGNATURE _____ DATE _____

BELL CO. INC.

Architectural Signage Systems

106 Morrow Ave PO Box 92
Trussville, AL 35173
205-655-2135
FAX 205-655-2138
800-828-3564 • CALL TODAY
www.bellcoinc.com